

## Covid Safety Plan Site Specific Information



### COVID Safety Plan Site Specific Information W.E. Mitchell Middle School

#### Campus Ingress/Egress

Campus will be open to students, staff, and essential visitors only.

Students are to arrive on campus no earlier than 10 minutes prior to campus start time and depart within 10 minutes of dismissal. When students arrive, they will be directed to go to their grade level designated area. An administrator will be assigned to each area. Please see campus map for designated ingress/egress routes.

- 6th grade - BOYS blacktop (Dr. Garcia)
- 7th grade - GIRLS blacktop (Mr. Botsford)
- 8th grade - QUAD (Ms. Strawn)

A reopening video was created and shared with students in Advisory. A slideshow of the content was also created, shared, and will be posted on the website.

#### Sanitizing

Sanitization stations will be strategically placed throughout campus and students will be asked to sanitize and/or wash hands regularly. Each classroom has designated sanitization items.

Mitchell Middle School will follow FCUSD Sanitation and Cleaning guidance. Classrooms, restrooms, common areas, and high touch points are priority areas and will be sanitized frequently.

#### Social Distancing/Face coverings

Classroom desks and furniture have been placed and floor markings have been added to ensure safe distancing. Dots and arrows are painted throughout campus to indicate flow of traffic and promote distancing.

Face coverings are mandatory for all who are on campus.

#### Lunch

Lunch will be served in the cafeteria beginning at 12:03pm (Mon. – Fri.) and will serve students with a grab and go.

#### Communication

Weekly, parents are notified that a new version of *The Week at a Glance* has been posted. The website is updated regularly and as needed, texts, emails, and phone voicemails are sent. In addition, *Coffee with the Principal* will be

## Covid Safety Plan Site Specific Information

on 3/16, 4/20, and 5/18. Slideshow presentations from *Coffee with the Principal* are posted online and included in *The Week at a Glance*. A list of staff and email addresses is posted and families can email any safety concerns to Amy Strawn, Principal, [astrawn@fcusd.org](mailto:astrawn@fcusd.org).

## Materials/Preparing for Success

To be prepared for each day, students will be asked to bring the following:

- Face mask
- Backpack with school supplies
- Chromebook fully charged
- Water bottle
- Mitchell planner

## Campus Map Ingress/Egress Routes

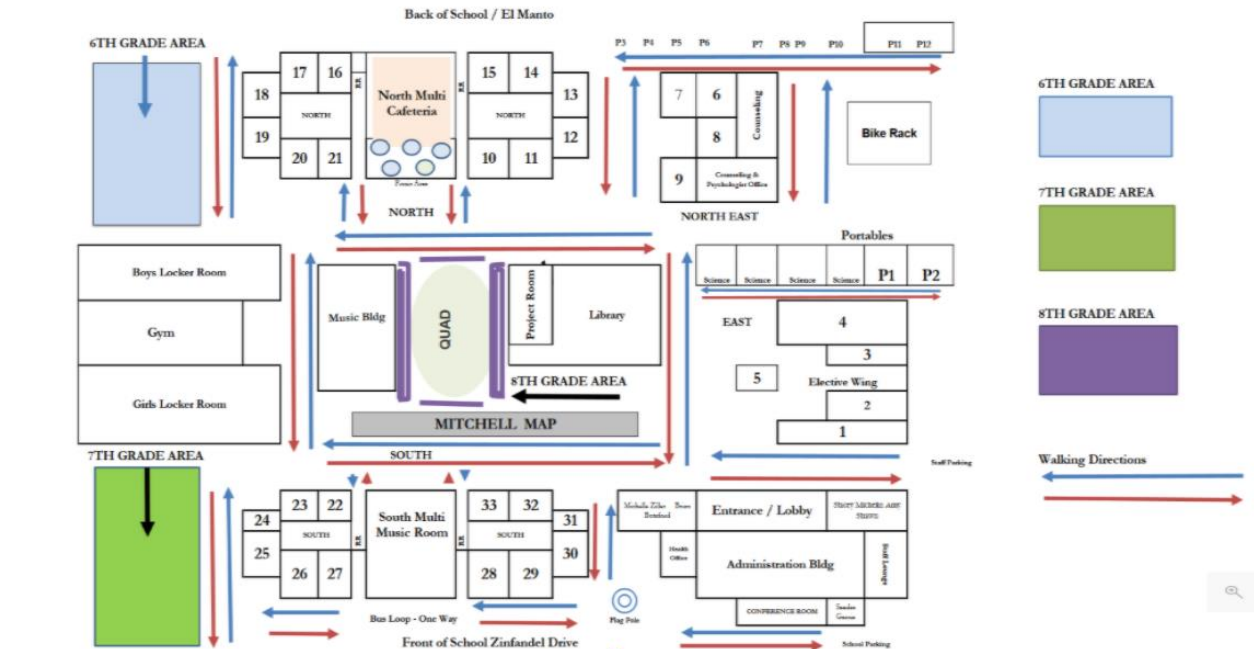

# Covid Safety Plan Site Specific Information

## Hybrid Bell Schedule

### W.E. Mitchell Hybrid Bell Schedule (AA/BB) Spring 2021

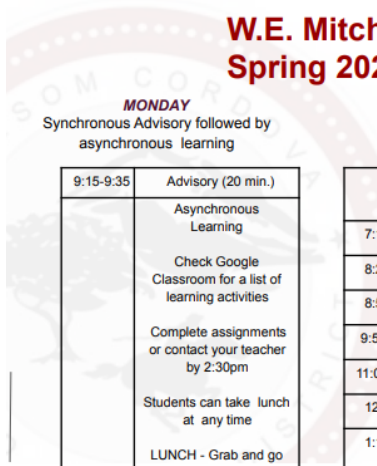

**MONDAY**  
Synchronous Advisory followed by asynchronous learning

**TUESDAY, WEDNESDAY, THURSDAY, FRIDAY**  
Longer synchronous learning time with asynchronous learning at the end of the day

9:15-9:35	Advisory (20 min.)
	Asynchronous Learning
	Check Google Classroom for a list of learning activities
	Complete assignments or contact your teacher by 2:30pm
	Students can take lunch at any time
	LUNCH - Grab and go available on site (12:03-1:15)

	TUESDAY A Day	WEDNESDAY A Day	THURSDAY B Day	FRIDAY B Day
7:15 - 8:15	0 Period (60 min.)*		0 Period (60 min.)*	
8:25 - 8:45	Advisory (20 min.)	Advisory (20 min.)	Advisory (20 min.)	Advisory (20 min.)
8:51 - 9:51	1st Period (60 min.)	4th Period (60 min.)	1st Period (60 min.)	4th Period (60 min.)
9:57 - 10:57	2nd Period (60 min.)	5th Period (60 min.)	2nd Period (60 min.)	5th Period (60 min.)
11:03 - 12:03	3rd Period (60 min.)	6th Period (60 min.)	3rd Period (60 min.)	6th Period (60 min.)
12:03-1:15	LUNCH - Grab and go	LUNCH - Grab and go	LUNCH - Grab and go	LUNCH - Grab and go
1:15 - 3:00	Intervention and Asynchronous Learning	Intervention and Asynchronous Learning	Intervention and Asynchronous Learning	Intervention and Asynchronous Learning
Total Instructional Minutes	Mondays: 20 Synchronous / 230 Asynchronous Tuesdays – Fridays: 200 In-Person / 105 Asynchronous each day * Zero Period is for students enrolled in this additional class (60 minutes in person or synchronous)			